



<http://atx-led.com>

AL-WPS-53v30w
AL-WPS-51v10ws
AL-WPS-24vac20w
AL-WPS-24v30w

In Wall power supply

low voltage

Meets NEC standards for
class separation

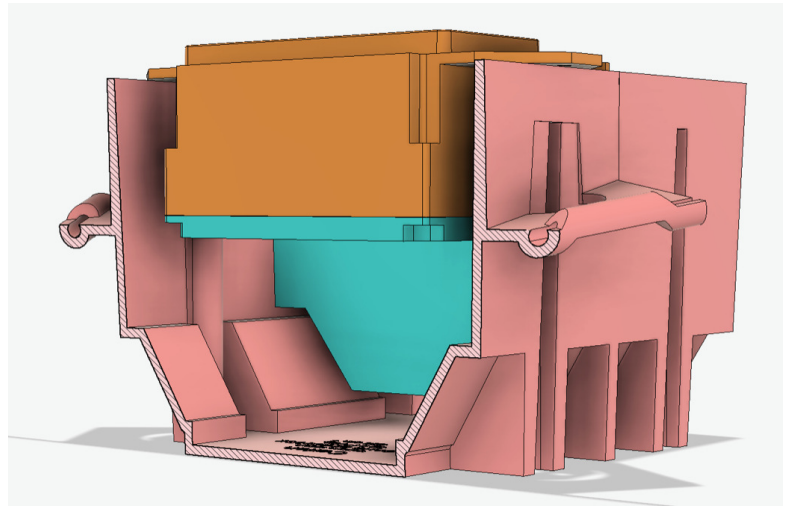

[Product Description - AL-WPS power supplies](#)

These power supplies are designed for Class 2 applications, with ETL IEC 62368-1 listing, high power factor and cool operation. Each model fits into a standard 2 gang US style wall box, with a built in separator to safely isolate the 120vac class 1 compartment away from the Class 2 wiring.

As a member of the ATX LED LVDC family, this device is used to power low voltage Class 2 loads, intended to provide a in-wall power supply – not subject to accidental disconnection.

The 53v30w model is intended for ATX LED 51v and 53v fixtures, with our without dimming. For example, a AL-WS-DR2 with 5 DL-120 fixtures and tunable white

The 51v10ws model is intended for ATX LED smoke and combo detectors, with 22kv surge protection

The 24vac20w model is intended for doorbell and HVAC applications

The 24v30w model is intended for legacy 24v strip light projects

Specifications

120vac connection	Line, Neutral, Earth Ground AWG18 stranded wire, Black, White, Green
NRTL	UL 62368-1, Class 2, LPS
DC Output	AWG18 stranded wire, Red and Black
Output voltage	Nameplate +- 2%
Output current	See nameplate
Power Factor	Not PF corrected.
Input voltage range	100v to 250v , 50-60 Hz
Input Wattage	Nameplate + 10%
Standby power consumption	DoE Class 6,
Conversion efficiency	92% at full load
Inrush	Inrush current limited
Operating Temperature	0°C ~ 50°C
Size	US 1 gang, with divider
Dimming	None – see other products for dimming
FCC and interference	All outputs are RF filtered for minimal Interference

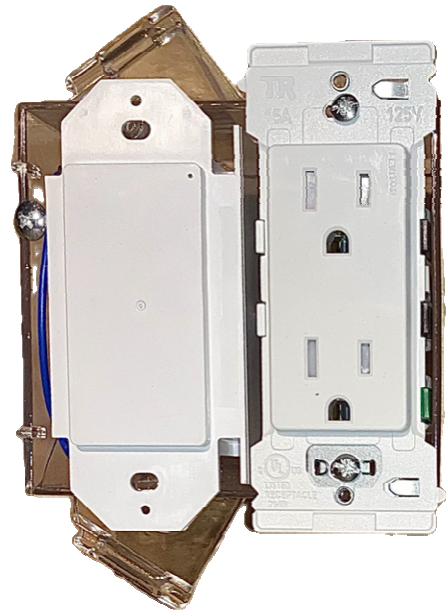

Ordering part numbers

Model	Output Voltage	Output Wattage	Output Current	Used With
AL-WPS-51v65w	51vdc	65	1200 mA	LED Fixtures
AL-WPS-51v10wx	51vdc	10	200 mA	Smoke Detectors
AL-WPS-24v30w	24vdc	30	1200 mA	Legacy Strip lights
AL-WPS-24vac20w	24vac	20	800 mA	Doorbells, HVAC

Sharing with a 120vac outlet Rear View

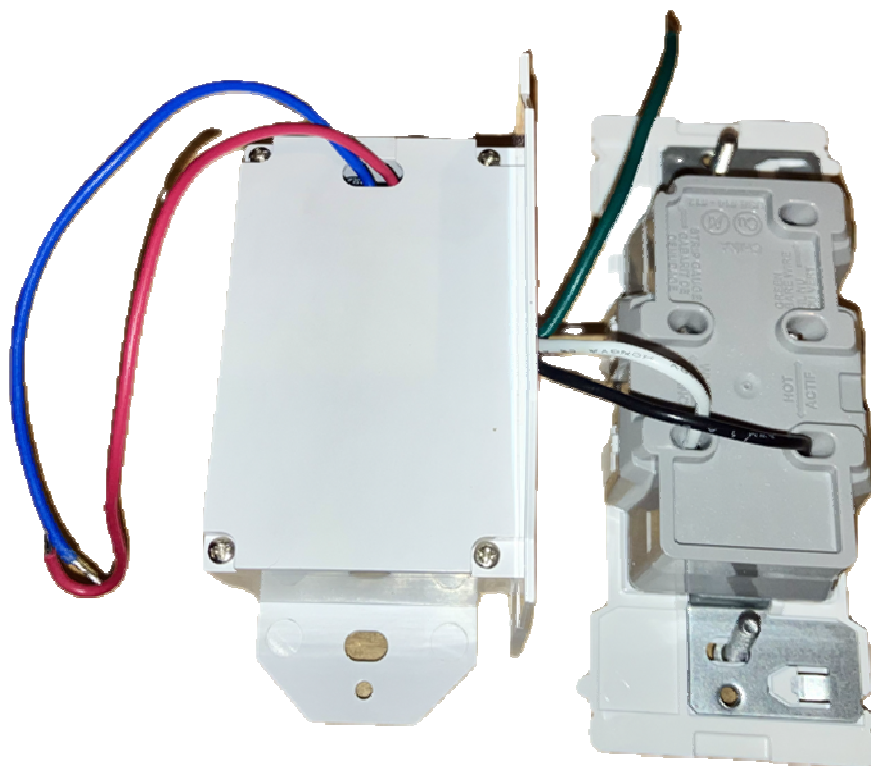

Left – WPS Right 120vac outlet

